

PRELIMINARY PLAN

Notice of New Subdivision Parcel

Date: 28-Oct-98
 To: CPU - Leigh
 Planning File No: 6598156
 Parent Assessment No: 07000/579.09 - P17066
 Planning Administration - Jane

Locality Diagram



Schedule of Easements

Purpose	Servient Tenement
Right to store and convey water	Lot 1

REGISTERED OWNER: T.B
 COMPRISED IN: CT:
 LOCAL AUTHORITY: Ro:
 TOTAL AREA: 24

I, Fergus Campbell Commis
 certify that this scheme
 by me in accordance w
 Resource Management

NOTES:
 1) Areas and dimension
 Land Transfer Surve,

Scale

100m 0m 100m
 1:10,000

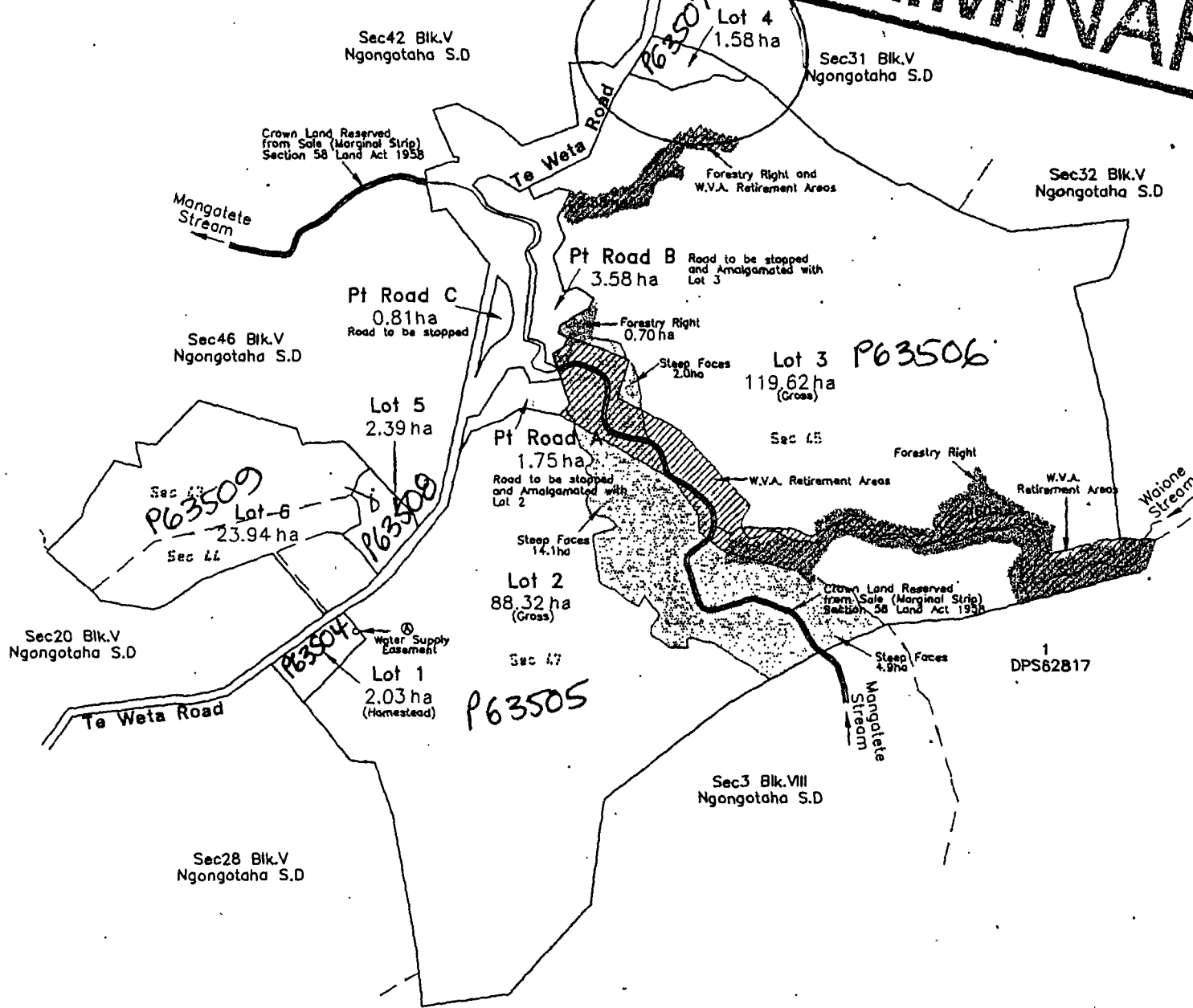

PROJECT: Lots 1 - 6 being a proposed subdivision of Sections 43,44,45, & 47 BlockV Ngongotaha SD and Pts A-C Road to be closed

T.B.P & R.A Coles
 Te Weta Road

REFERENCE: 4869-1
 SHEET 1 OF 1 SHEETS
 DRAWN: 1:10,000

Parent File - P17066

PRELIMINARY PLAN



Locality Diagram

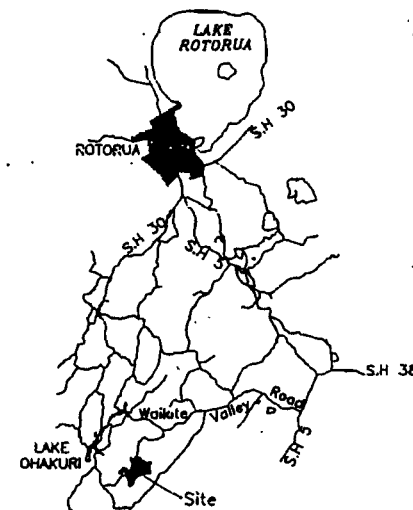

Schedule of Easements

Purpose	Servient Tenement	Shown	Dominant Tenement
Right to store and convey water	Lot 1	(A)	Lots 2, 5, 6 & Pt Road C

REGISTERED OWNER: T.B.P. & R.A. Coles
 COMPRISED IN: CT 50A/63
 LOCAL AUTHORITY: Rotorua District Council
 TOTAL AREA: 247.71ha

I, Fergus Campbell Cumming, Registered Surveyor, hereby certify that this scheme plan has been prepared by me in accordance with the provisions of the Resource Management Act 1991.

[Signature] 23/10/95
 NOTES:

- 1) Areas and dimensions are subject to Land Transfer Survey

Scale 1:10000

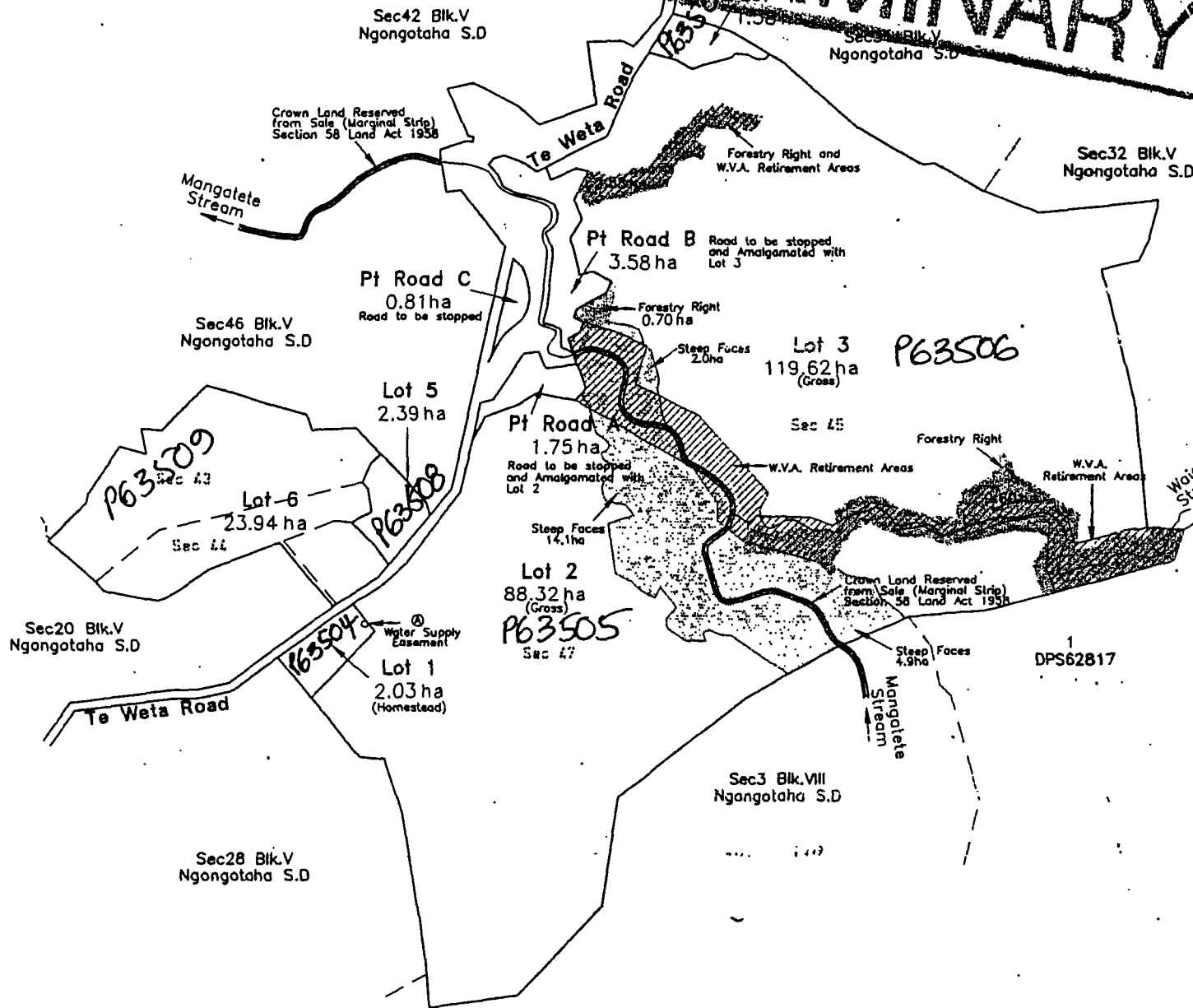
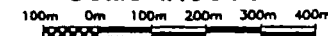

FILE REFERENCE	1000	SHEET TITLE	T.B.P. & R.A. Coles Te Weta Road	PROJECT	Lots 1 - 6 being a proposed subdivision of Sections 43, 44, 45, & 47 Block V Ngongotaha SD and Pts A-C Road to be closed	ARCHIVE	REFERENCE No	4869-1	SHEET 1 OF 1 SHEETS	SCALE 1:10,000
DATE		DESIGNED		DRAWN		DATE				
BY		CHECKED		APPROVED						